

MCPS Content Management System (EpiServer) Training

How to Create Anchor Links

1 – In the Epi content editor, click anywhere in the content block where you want to add the anchor and then select the **Anchor** button.

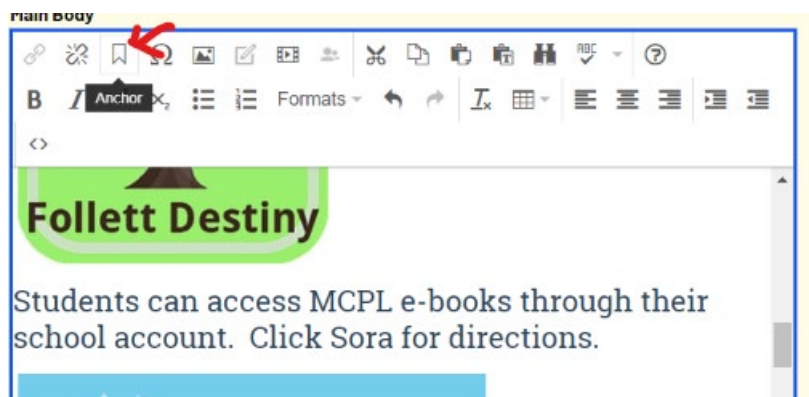

2 – Enter the **ID** for the anchor. The ID should contain no spaces or special characters.

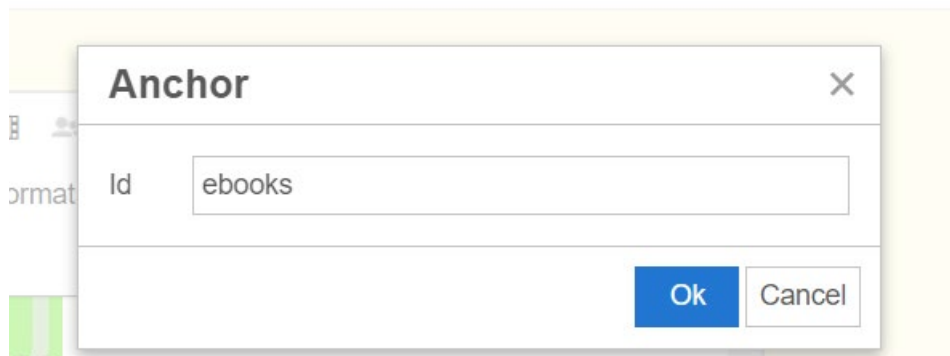

3 – Select the text for the link and click the **Insert/Edit Link** button.

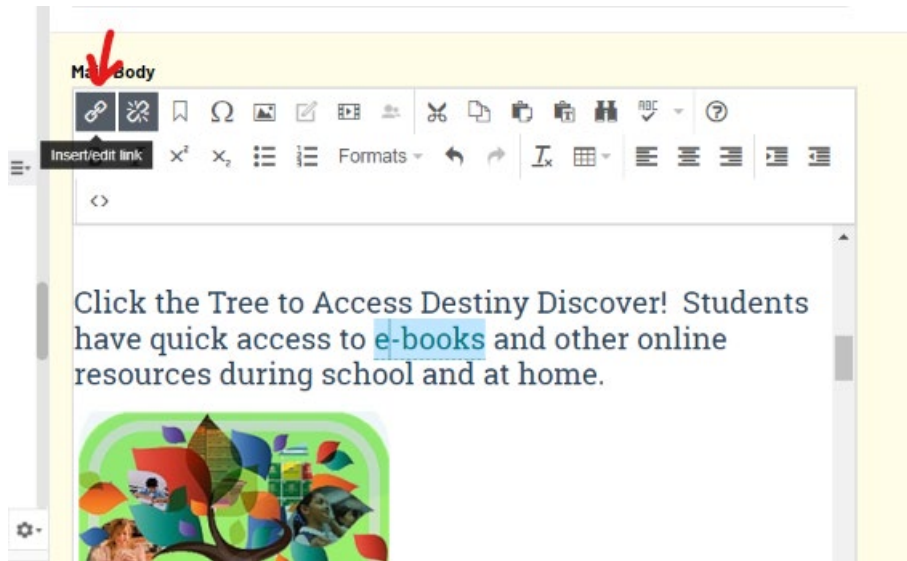

4 – In the **Edit Link** window, select the radio button for **Anchor** and select the anchor name you added. All anchors on the page should appear in the dropdown as options.

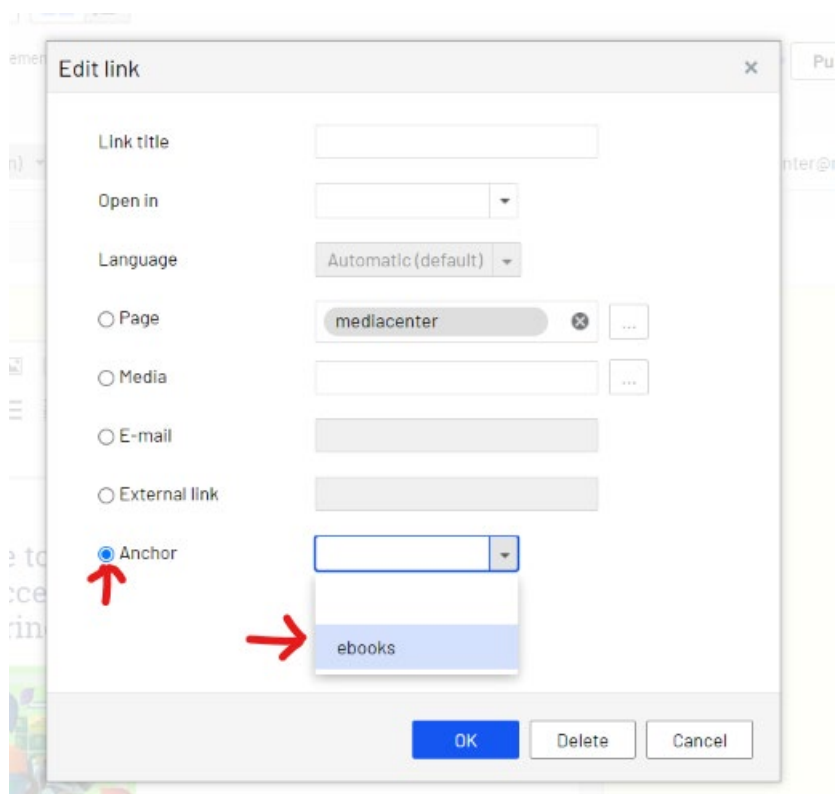

5- Click **OK**.