



**Charles W. Woodward High School Project:  
Phase 2: Work Session No. 3**

October 21, 2021



## The Webinar Process...

This meeting is taking place as a Zoom **Webinar**.

- Camera and microphone access will be limited to Panelists.

The presentation will be followed by a brief Poll

- Please participate!

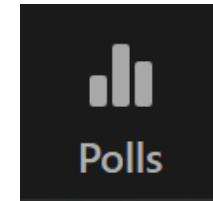

**And**

A Question and Answer Session.

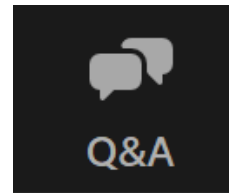

- Q&A Session will be held after the poll, please save questions for this section
- Please click on the Question & Answer Icon to type in your questions.
- A host will read your question and a panelist will respond, as time allows.
- For further questions, contact [Jonathan\\_O\\_Acosta@mcpsmd.org](mailto:Jonathan_O_Acosta@mcpsmd.org)

**Thank you for coming!**

# Agenda

**I. Introduction/Welcome**

**II. Phase 2 – Building Concept**

**III. Phase 2 - Site Options**

**IV. Participant Poll**

**V. Question and Answer Session**

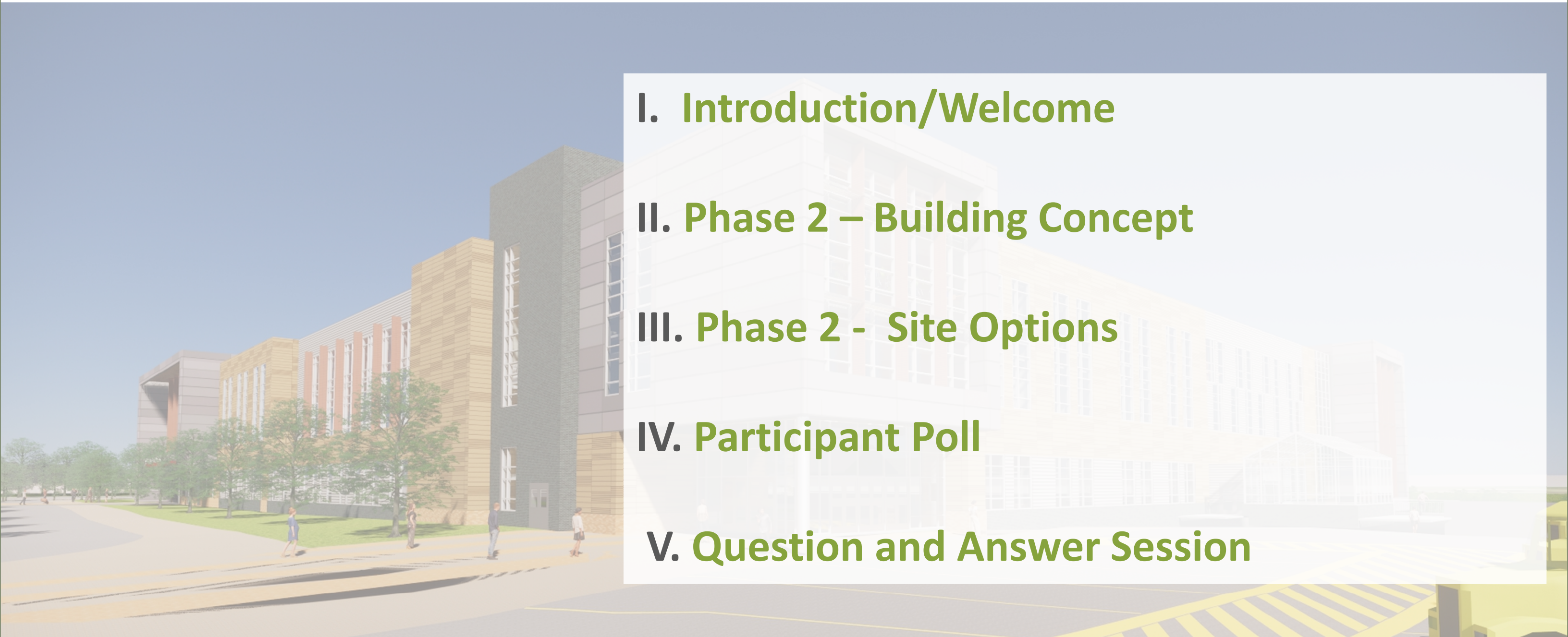

# Phase 2 Building Concept: Graphic Program

## PERFORMING ARTS SPACES

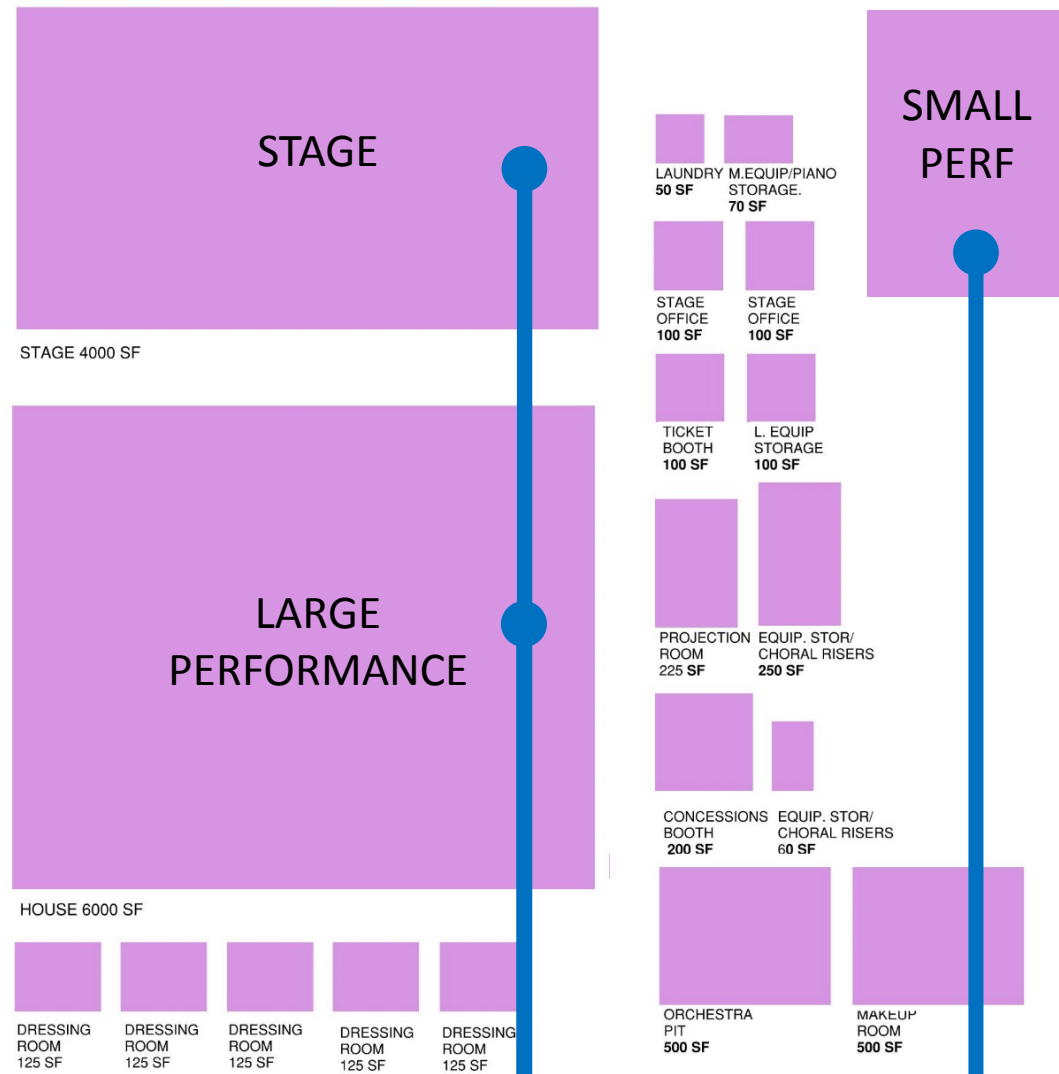

## ART CORE SPECIALTY SPACES - MUSIC

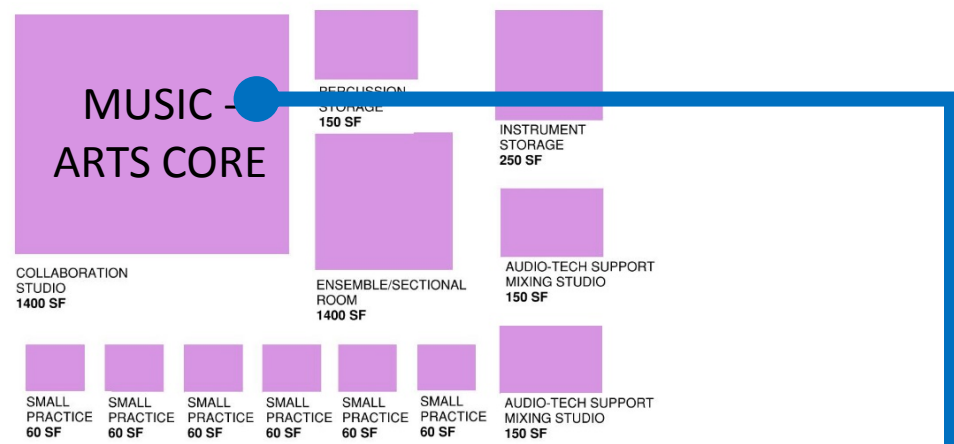

## ART CORE SPECIALTY SPACES - ART

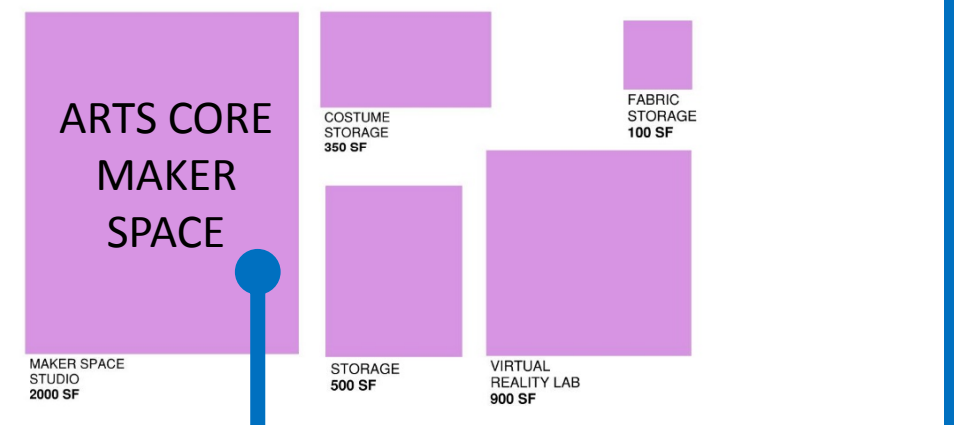

## PHYSICAL EDUCATION

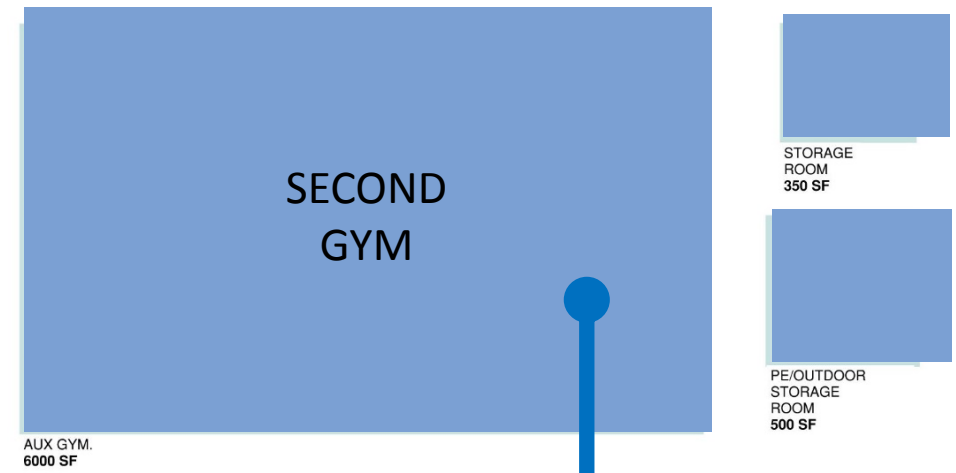



# MCPS Stadiums



Poolsville High School



Northwood High School



Sherwood High School

- Examples of both single and double-sided grandstands
- Proximity to residences



Albert Einstein High School



Bethesda Chevy Chase High School

**QUESTIONS?**

**Thank you!**