



YOTI N.N. & ASSOCIATES, INC (YNN)
Industrial Hygiene and Environmental Services

November 3, 2024

Mr. Derek Kwon
Montgomery County Public School
Division of Sustainability and Compliance
8301 Turkey Thicket Drive,
Gaithersburg, Maryland 20879

RE: Fiber-in-air Sampling – Joann Leleck Elementary School

Dear Mr. Kwon:

Yoti N. N. & Associates, Inc. (YNN) performed a fiber-in-air sampling of Joann Leleck Elementary school (Site) per Montgomery County Public School (MCPS), Division of Sustainability and Compliance (DSC) request. The Site is located at 710 Beacon Road in Silver Spring, Maryland. The sampling request was made pursuant of building fire resulting in total collapse of the building structure. YNN mobilized to the Site and has been conducting air sampling, beginning on September 25, 2024 and will continue to collect environmental air samples until instructed otherwise.

The report present is for the fiber-in-air samples collected on October 28, 2024 through November 3, 2024.

YNN's Industrial Hygienist, Mr. John Ndanga, conducted the fiber-in-air sampling. The samples were collected along the fence that has been erected around the demolished building structure.

YNN collected the Phase Contrast Microscopy (PCM) air samples using low-volume air sampling pumps which were calibrated on Site with a rotameter. Collected air samples were analyzed using Phase Contrast Microscopy (PCM) in accordance with the National Institute for Occupational Safety and Health (NIOSH) Method 7400. PCM analysis was performed by assigned Industrial Hygienists who have completed the NIOSH 582 equivalency course.

Refer to the attached field data sheets and drawing for detailed sample locations and air sampling results. Based on the air sampling data collected, there is no evidence that elevated background fiber levels exist within the area of concern at Joann Leleck Elementary School.

YNN continues to perform fiber-in-air sampling at the Site.

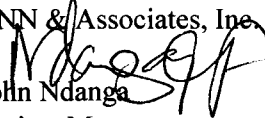
Sincerely,
YNN & Associates, Inc.

John Ndanga
Project Manager



YOTI N.N. & ASSOCIATES, INC (YNN)

Industrial Hygiene and Environmental Services

Page: 1 of 1

DAILY LOG SHEET

Date: 10/28/2024

Job Name: Joann Leleck ES

Time	Remarks
6:30	YNN's field IH arrived at Joann Leleck Elementary school (Site) to perform environmental (fiber-in-air) sampling following the fire incident which resulted in almost total colaps of the structure. The Site is located at 710 Beacon Road in Silver Spring, Maryland.
	Mr. Chris Marro (Sr. General Superintendent) with Gilbane informed IH that demo crew will continue to separate scrap metal, bricks and concrete from demo debris and also knocking down portables. Demo company is Bowen & Kron.
7:15	IH calibrated low volume air samplers with a rotameter and commenced environmental air sampling along the erected fence surrounding the demolished building structure.
	Air samplers were strategically positioned to capture air quality in different sections of the Site.
	The excavators will continue to demo portables and continue loading up separate dumpsters with scrap metal, concrete/bricks and demo debris. Two workers continue to utilize a water truck with a water cannon for dust suppression to minimize airborne particles during the demo operation. The demo crew will continue to wet down the contaminated demo debris and load into dumpster. A-L Abatement will continue to lineup dumpsters with 6 mil poly as the dump trucks arrive to haul away the contaminated deris. Once lined up with 6 mil poly, the demo crew loads them up with contaminated waste and hauled away to the landfill for proper disposal.
11:00	IH performed a walk through of the area. The demo operators continued to perform demo of portables and loading up dumpsters. Dust suppression via water cannon continues.
	Air samplers observed to be running properly. Dump trucks continued to haul away dumpster loads of contaminated debris separated from brick/concrete and scrap metal. The scrap metals are also being hauled away for recycling. Separation of contaminated debris from scrap metal continues. Demo operation observed to be moving along without any problems. Dust suppression with water cannon to minimize airborne particles during demo continues. A total of eleven dumpsters were pulled away from the Site loaded with contaminated demo debris to the landfill for proper disposal. The debris was wetted down with the water cannon before being loaded into the dumpsters and hauled away to the landfill for proper disposal.
14:00-14:30	IH collected air samples and samplers and exited the Site.
18:00-19:30	IH prepared air samples and performed air sample analysis via PCM. All air samples were below 0.01 f/cc.



YOTI N.N. & ASSOCIATES, INC (YNN)
Industrial Hygiene and Environmental Services

AIR SAMPLE DATA SHEET

Client: MCPS Project Name: Joann Leleck Elementary School
 Work Area: Along the Fence Date: 10/28/2024

Sample NO.	Location / Code Relation to work	FLOW RATE		Time		Total Time	Total Volume	Fibers	Fibers CC
		Start	End	On	Off				
102824-1	Environmental-Main Entrance on Fence	3	3	7:15	14:00	405	1215	6	< 0.01
102824-2	Environmental-Facing White Apartments	3	3	7:16	14:01	405	1215	4.5	< 0.01
102824-3	Environmental-Facing House 705	3	3	7:18	14:03	405	1215	7.5	< 0.01
102824-4	Environmental-Facing Brown Apts.	3	3	7:21	14:05	404	1212	9	< 0.01
102824-5	Environmental-Facing Brown Apts.	3	3	7:22	14:06	404	1212	10.5	< 0.01
102824-6	Environmental-Facing St. Camillus	3	3	7:27	14:11	404	1212	5	< 0.01
102824-7	Environmental-Facing St. Camillus	3	3	7:28	14:12	404	1212	4.5	< 0.01
102824-8	Environmental-Facing Playground	3	3	7:30	14:16	406	1218	3.5	< 0.01
102824-9	Environmental-Facing Playground	3	3	7:31	14:17	406	1218	4.5	< 0.01
102824-10	Environmental-Facing Gym	3	3	7:35	14:25	410	1230	6.5	< 0.01
102824-11	Environmental-Facing Gym	3	3	7:36	14:26	410	1230	5.5	< 0.01
102824-12	Environmental-Facing Field	3	3	7:36	14:28	412	1236	4.5	< 0.01
Abbreviations: PRE - Pre-Abatement Sampling OGBA - Outside Glove Bag Area IGBA - Inside Glove Bag Area PRS - Personal Sample IBT - Inside Barrier Tape BLK - Blank IWA - Inside Work Area OWA - Outside Work Area OBT - Outside Barrier Tape NFO - No Fibers Observed Post - Final Clearance monitoring AMB - Ambient CB - Critical Barrier									

Analyst: John Ndanga
 Date: 10/28/2024



YOTI N.N. & ASSOCIATES, INC (YNN)
 Industrial Hygiene and Environmental Services

AIR SAMPLE DATA SHEET

Client: MCPS **Project Name:** Joann Leleck Elementary School
Work Area: Along the Fence **Date:** 10/28/2024

Sample NO.	Location / Code Relation to work	FLOW RATE		Time		Total Volume	Fibers	Fibers CC
		Start	End	On	Off			
102824-13	Environmental-Facing Field	3	3	7:38	14:29	1233	5	< 0.01
102824-14	BLK							NFO
102824-15	BLK							NFO

Abbreviations: PRE - Pre-Abatement Sampling
 OGBA - Outside Glove Bag Area
 IGBA - Inside Glove Bag Area
 PRS - Personal Sample
 IBT - Inside Barrier Tape
 BLK - Blank
 IWA - Inside Work Area
 OWA - Outside Work Area
 OBT - Outside Barrier Tape
 NFO - No Fibers Observed
 Post - Final Clearance monitoring
 AMB - Ambient
 CB - Critical Barrier

Analyst: John Ndanga
Date: 10/28/2024



DAILY LOG SHEET

Date: 10/29/2024

Job Name: Joann Leleck ES

Time	Remarks
6:30	YNN's field IH arrived at Joann Leleck Elementary school (Site) to perform environmental (fiber-in-air) sampling following the fire incident which resulted in almost total colaps of the structure. The Site is located at 710 Beacon Road in Silver Spring, Maryland.
	Mr. Chris Marro (Sr. General Superintendent) with Gilbane informed IH that demo crew will continue to separate scrap metal, bricks and concrete from demo debris and also knocking down portables. Demo company is Bowen & Kron.
7:25	IH calibrated low volume air samplers with a rotameter and commenced environmental air sampling along the erected fence surrounding the demolished building structure.
	Air samplers were strategically positioned to capture air quality in different sections of the Site. The excavators will complete demo of portables and continue loading up separate dumpsters with scrap metal, concrete/bricks and demo debris. Workers continue to utilize a water truck with a water cannon for dust suppression to minimize airborne particles during the demo operation. The demo crew will continue to wet down the contaminated demo debris and load into dumpster. A-L Abatement will continue to lineup dumpsters with 6 mil poly as the dump trucks arrive to haul away the contaminated deris. Once lined up with 6 mil poly, the demo crew loads them up with contaminated waste and hauled away to the landfill for proper disposal.
11:30	IH performed a walk through of the area. The demo operators continued to perform demo of portables and loading up dumpsters. Dust suppression via water cannon continues.
	Air samplers observed to be running properly. Dump trucks continued to haul away dumpster loads of contaminated debris separated from brick/concrete and scrap metal. The scrap metals are also being hauled away for recycling. Separation of contaminated debris from scrap metal continues. Demo operation observed to be moving along smoothly. Dust suppression with water cannon to minimize airborne particles during demo continues. A total of eleven dumpsters were pulled away from the Site loaded with contaminated demo debris to the landfill for proper disposal. The debris was wetted down with the water cannon before being loaded into the dumpsters and hauled away to the landfill for proper disposal.
14:00-14:30	IH collected air samples and samplers and exited the Site.
18:30-20:00	IH prepared air samples and performed air sample analysis via PCM. All air samples were below 0.01 f/cc.



YOTI N.N. & ASSOCIATES, INC (YNN)

Industrial Hygiene and Environmental Services

AIR SAMPLE DATA SHEET

Client: MCPS

Project Name: Joann Leleck Elementary School

Work Area: Along the Fence

Date: 10/29/2024

Sample NO.	Location / Code Relation to work	FLOW RATE		Time		Total Time	Total Volume	Fibers	Fibers CC
		Start	End	On	Off				
102924-1	Environmental-Main Entrance on Fence	3	3	7:25	14:00	395	1185	2.5	< 0.01
102924-2	Environmental-Facing White Apartments	3	3	7:26	14:03	397	1191	3.5	< 0.01
102924-3	Environmental-Facing House 705	3	3	7:28	14:04	396	1188	3	< 0.01
102924-4	Environmental-Facing Brown Apts.	3	3	7:30	14:06	396	1188	7	< 0.01
102924-5	Environmental-Facing Brown Apts.	3	3	7:31	14:07	396	1188	5.5	< 0.01
102924-6	Environmental-Facing St. Camillus	3	3	7:40	14:10	390	1170	3	< 0.01
102924-7	Environmental-Facing St. Camillus	3	3	7:41	14:11	390	1170	4.5	< 0.01
102924-8	Environmental-Facing Playground	3	3	7:43	14:14	391	1173	2.5	< 0.01
102924-9	Environmental-Facing Playground	3	3	7:44	14:15	391	1173	3.5	< 0.01
102924-10	Environmental-Facing Gym	3	3	7:47	14:17	390	1170	6	< 0.01
102924-11	Environmental-Facing Gym	3	3	7:48	14:18	390	1170	4.5	< 0.01
102924-12	Environmental-Facing Field	3	3	7:50	14:20	390	1170	7	< 0.01

Abbreviations:	PRE - Pre-Abatement Sampling	BLK - Blank	NFO - No Fibers Observed
	OGBA - Outside Glove Bag Area	IWA - Inside Work Area	Post - Final Clearance monitoring
	IGBA - Inside Glove Bag Area	OWA - Outside Work Area	AMB - Ambient
	PRS - Personal Sample	OBT - Outside Barrier Tape	CB - Critical Barrier
	IBT - Inside Barrier Tape		

Analyst: John Ndanga

Date: 10/29/2024



AIR SAMPLE DATA SHEET

Client: MCPS **Project Name:** Joann Leleck Elementary School
Work Area: Along the Fence **Date:** 10/29/2024

Sample NO.	Location / Code Relation to work	FLOW RATE		Time		Total Time	Total Volume	Fibers	Fibers CC
		Start	End	On	Off				
102924-13	Environmental-Facing Field	3	3	7:51	14:22	391	1173	5.5	< 0.01
102924-14	BLK								NFO
102924-15	BLK								NFO

Abbreviations: PRE - Pre-Abatement Sampling
 OGBA - Outside Glove Bag Area
 IGBA - Inside Glove Bag Area
 PRS - Personal Sample
 IBT - Inside Barrier Tape
 BLK - Blank
 IWA - Inside Work Area
 OWA - Outside Work Area
 OBT - Outside Barrier Tape
 NFO - No Fibers Observed
 Post - Final Clearance monitoring
 AMB - Ambient
 CB - Critical Barrier

Analyst: John Ndanga
Date: 10/29/2024



YOTI N.N. & ASSOCIATES, INC (YNN)

Industrial Hygiene and Environmental Services

DAILY LOG SHEET

Date: 10/30/2024

Job Name: Joann Leleck ES

Time	Remarks
6:30	YNN's field IH arrived at Joann Leleck Elementary school (Site) to perform environmental (fiber-in-air) sampling following the fire incident which resulted in almost total colaps of the structure. The Site is located at 710 Beacon Road in Silver Spring, Maryland.
	Mr. Chris Marro (Sr. General Superintendent) with Gilbane informed IH that demo crew will continue to separate scrap metal, bricks and concrete from demo debris and also knocking down portables. Demo company is Bowen & Kron.
7:30	IH calibrated low volume air samplers with a rotameter and commenced environmental air sampling along the erected fence surrounding the demolished building structure.
	Air samplers were strategically positioned to capture air quality in different sections of the Site.
	The excavators will continue loading up separate dumpsters with scrap metal and demo debris.
	Workers continue to utilize a water truck with a water cannon for dust suppression to minimize airborne particles during the demo operation.
	The demo crew will continue to wet down the contaminated demo debris and load into the dumpster. A-L Abatement will continue to lineup dumpsters with 6 mil poly as the dump trucks arrive to haul away the contaminated deris. Once lined up with 6 mil poly, the demo crew loads them up with contaminated waste and hauled away to the landfill for proper disposal.
11:00	IH performed a walk through of the area. The demo operators continued to to load up dump truck after dump truck with contaminated demo debris. Dust suppression via watering continues.
	Air samplers observed to be running properly. Dump trucks continued to haul away dumpster loads of contaminated debris separated from brick/concrete and scrap metal. The scrap metals are also being hauled away for recycling. Separation of contaminated debris from scrap metal continues. Demo operation observed to be moving along smoothly. Dust suppression with water cannon to minimize airborne particles during demo continues. A total of eleven dumpsters were pulled away from the Site loaded with contaminated demo debris to the landfill for proper disposal. The debris was wetted down with the water cannon before being loaded into the dumpsters and hauled away to the landfill for proper disposal.
14:00-14:30	IH collected air samples and samplers and exited the Site.
19:00-20:30	IH prepared air samples and performed air sample analysis via PCM. All air samples were below 0.01 f/cc.



YOTI N.N. & ASSOCIATES, INC (YNN)

Industrial Hygiene and Environmental Services

AIR SAMPLE DATA SHEET

Client: MCPS

Project Name: Joann Leleck Elementary School

Work Area: Along the Fence

Date: 10/30/2024

Sample NO.	Location / Code Relation to work	FLOW RATE		Time		Total Time	Total Volume	Fibers	Fibers CC
		Start	End	On	Off				
103024-1	Environmental-Main Entrance on Fence	3	3	7:30	14:00	390	1170	3.5	< 0.01
103024-2	Environmental-Facing White Apartments	3	3	7:31	14:01	390	1170	4.5	< 0.01
103024-3	Environmental-Facing House 705	3	3	7:33	14:03	390	1170	2.5	< 0.01
103024-4	Environmental-Facing Brown Apts.	3	3	7:35	14:07	392	1176	5	< 0.01
103024-5	Environmental-Facing Brown Apts.	3	3	7:36	14:08	392	1176	6.5	< 0.01
103024-6	Environmental-Facing St. Camillus	3	3	7:43	14:12	389	1167	4	< 0.01
103024-7	Environmental-Facing St. Camillus	3	3	7:44	14:14	390	1170	5.5	< 0.01
103024-8	Environmental-Facing Playground	3	3	7:46	14:16	390	1170	3	< 0.01
103024-9	Environmental-Facing Playground	3	3	7:47	14:17	390	1170	3.5	< 0.01
103024-10	Environmental-Facing Gym	3	3	7:50	14:21	391	1173	5	< 0.01
103024-11	Environmental-Facing Gym	3	3	7:51	14:22	391	1173	4	< 0.01
103024-12	Environmental-Facing Field	3	3	7:53	14:20	387	1161	5.5	< 0.01
Abbreviations:									
PRE - Pre-Abatement Sampling				BLK - Blank		NFO - No Fibers Observed			
OGBA - Outside Glove Bag Area				IWA - Inside Work Area		Post - Final Clearance monitoring			
IGBA - Inside Glove Bag Area				OWA - Outside Work Area		AMB - Ambient			
PRS - Personal Sample				OBT - Outside Barrier Tape		CB - Critical Barrier			
IBT - Inside Barrier Tape									

Analyst: John Ndanga

Date: 10/30/2024



YOTI N.N. & ASSOCIATES, INC (YNN)

Industrial Hygiene and Environmental Services

AIR SAMPLE DATA SHEET

Client: MCPS Project Name: Joann Leleck Elementary School
 Work Area: Along the Fence Date: 10/30/2024

Sample NO.	Location / Code Relation to work	FLOW RATE		Time		Total Time	Total Volume	Fibers	Fibers CC
		Start	End	On	Off				
103024-13	Environmental-Facing Field	3	3	7:55	14:25	390	1170	4	< 0.01
103024-14	BLK								NFO
103024-15	BLK								NFO
Abbreviations:		PRE - Pre-Abatement Sampling		BLK - Blank		NFO - No Fibers Observed			
		OGBA - Outside Glove Bag Area		IWA - Inside Work Area		Post - Final Clearance monitoring			
		IGBA - Inside Glove Bag Area		OWA - Outside Work Area		AMB - Ambient			
		PRS - Personal Sample		OBT - Outside Barrier Tape		CB - Critical Barrier			
		IBT - Inside Barrier Tape							

Analyst: John Ndanga
 Date: 10/30/2024



YOTI N.N. & ASSOCIATES, INC (YNN)

Industrial Hygiene and Environmental Services

DAILY LOG SHEET

Date: 10/31/2024

Job Name: Joann Leleck ES

Time	Remarks
6:30	YNN's field IH arrived at Joann Leleck Elementary school (Site) to perform environmental (fiber-in-air) sampling following the fire incident which resulted in almost total colaps of the structure. The Site is located at 710 Beacon Road in Silver Spring, Maryland.
	Mr. Chris Marro (Sr. General Superintendent) with Gilbane informed IH that demo crew will continue to separate scrap metal, bricks and concrete from demo debris and also knocking down portables. Demo company is Bowen & Kron.
7:20	IH calibrated low volume air samplers with a rotameter and commenced environmental air sampling along the erected fence surrounding the demolished building structure.
	Air samplers were strategically positioned to capture air quality in different sections of the Site. The excavators will continue loading up separate dumpsters with scrap metal and demo debris. Workers continue to utilize a water truck with a water cannon for dust suppression to minimize airborne particles during the demo operation.
	The demo crew will continue to wet down the contaminated demo debris and load into the dumpster. A-L Abatement will continue to lineup dumpsters with 6 mil poly as the dump trucks arrive to haul away the contaminated waste. Once lined up with 6 mil poly, the demo crew loads them up with contaminated waste and hauled away to the landfill for proper disposal.
10:30	IH performed a walk through of the area. The demo operators continued to to load up dump truck after dump truck with contaminated demo debris. Dust suppression via watering continues.
	Air samplers observed to be running properly. Dump trucks continued to haul away dumpster loads of contaminated debris separated from brick/concrete and scrap metal. The scrap metals are also being hauled away for recycling. Separation of contaminated debris from scrap metal continues. Demo operation observed to be moving along smoothly. Dust suppression with water cannon to minimize airborne particles during demo continues. A total of eleven dumpsters were pulled away from the Site loaded with contaminated demo debris to the landfill for proper disposal. The debris was wetted down with the water cannon before being loaded into the dumpsters and hauled away to the landfill for proper disposal.
14:00-14:30	IH collected air samples and samplers and exited the Site.
18:00-19:30	IH prepared air samples and performed air sample analysis via PCM. All air samples were below 0.01 f/cc.



YOTI N.N. & ASSOCIATES, INC (YNN)

Industrial Hygiene and Environmental Services

AIR SAMPLE DATA SHEET

Client: MCPS

Project Name: Joann Leleck Elementary School

Work Area: Along the Fence

Date: 10/31/2024

Sample NO.	Location / Code Relation to work	FLOW RATE		Time		Total Time	Total Volume	Fibers	Fibers CC
		Start	End	On	Off				
103124-1	Environmental-Main Entrance on Fence	3	3	7:20	14:00	400	1200	3	< 0.01
103124-2	Environmental-Facing White Apartments	3	3	7:21	14:03	402	1206	4.5	< 0.01
103124-3	Environmental-Facing House 705	3	3	7:23	14:05	402	1206	3	< 0.01
103124-4	Environmental-Facing Brown Apts.	3	3	7:26	14:08	402	1206	6.5	< 0.01
103124-5	Environmental-Facing Brown Apts.	3	3	7:27	14:09	402	1206	5.5	< 0.01
103124-6	Environmental-Facing St. Camillus	3	3	7:35	14:15	400	1200	3	< 0.01
103124-7	Environmental-Facing St. Camillus	3	3	7:38	14:16	398	1194	4.5	< 0.01
103124-8	Environmental-Facing Playground	3	3	7:42	14:19	397	1191	2.5	< 0.01
103124-9	Environmental-Facing Playground	3	3	7:43	14:20	397	1191	3.5	< 0.01
103124-10	Environmental-Facing Gym	3	3	7:47	14:23	396	1188	6	< 0.01
103124-11	Environmental-Facing Gym	3	3	7:48	14:24	396	1188	3	< 0.01
103124-12	Environmental-Facing Field	3	3	7:52	14:27	395	1185	5.5	< 0.01
Abbreviations:									
	PRE - Pre-Abatement Sampling	BLK - Blank		NFO - No Fibers Observed					
	OGBA - Outside Glove Bag Area	IWA - Inside Work Area		Post - Final Clearance monitoring					
	IGBA - Inside Glove Bag Area	OWA - Outside Work Area		AMB - Ambient					
	PRS - Personal Sample	OBT - Outside Barrier Tape		CB - Critical Barrier					
	IBT - Inside Barrier Tape								

Analyst: John Ndanga

Date: 10/31/2024



YOTI N.N. & ASSOCIATES, INC (YNN)

Industrial Hygiene and Environmental Services

AIR SAMPLE DATA SHEET

Client: MCPS

Project Name: Joann Leleck Elementary School

Work Area: Along the Fence

Date: 10/31/2024

Sample NO.	Location / Code Relation to work	FLOW RATE		Time		Total Time	Total Volume	Fibers	Fibers CC
		Start	End	On	Off				
103124-13	Environmental-Facing Field	3	3	7:54	14:29	395	1185	5.5	< 0.01
103124-14	BLK								NFO
103124-15	BLK								NFO

Abbreviations: PRE - Pre-Abatement Sampling
OGBA - Outside Glove Bag Area
IGBA - Inside Glove Bag Area
PRS - Personal Sample
IBT - Inside Barrier Tape
BLK - Blank
IWA - Inside Work Area
OWA - Outside Work Area
OBT - Outside Barrier Tape
NFO - No Fibers Observed
Post - Final Clearance monitoring
AMB - Ambient
CB - Critical Barrier

Analyst: John Ndanga

Date: 10/31/2024



DAILY LOG SHEET

Date: 11/2/2024

Job Name: Joann Leleck ES

Time	Remarks
6:30	YNN's field IH arrived at Joann Leleck Elementary school (Site) to perform environmental (fiber-in-air) sampling following the fire incident which resulted in almost total colaps of the structure. The Site is located at 710 Beacon Road in Silver Spring, Maryland.
	Mr. Chris Marro (Sr. General Superintendent) with Gilbane informed IH that demo crew will continue to separate scrap metal, bricks and concrete from demo debris and loading up dump trucks with demo debris. Demo company is Bowen & Kron.
7:30	IH calibrated low volume air samplers with a rotameter and commenced environmental air sampling along the erected fence surrounding the demolished building structure.
	Air samplers were strategically positioned to capture air quality in different sections of the Site.
	The excavators will continue loading up separate dumpsters with scrap metal and demo debris.
	Workers continue to utilize a water truck with a water cannon for dust suppression to minimize airborne particles during the demo operation.
	The demo crew will continue to wet down the contaminated demo debris and load into the dumpster. A-L Abatement will continue to lineup dumpsters with 6 mil poly as the dump trucks arrive to haul away the contaminated waste. Once lined up with 6 mil poly, the demo crew loads them up with contaminated waste and hauled away to the landfill for proper disposal.
11:00	IH performed a walk through of the area. The demo operators continued to to load up dump trucks with contaminated demo debris. Dust suppression via watering continues.
	Air samplers observed to be running properly. Dump trucks continued to haul away dumpster loads of contaminated debris separated from brick/concrete and scrap metal. The scrap metals are also being hauled away for recycling. Separation of contaminated debris from scrap metal continues. Demo operation observed to be moving along smoothly. Dust suppression with water cannon to minimize airborne particles during demo continues. A total of 6 dump trucks were pulled away from the Site loaded with contaminated demo debris to the landfill for proper disposal. The debris was wetted down with the water cannon before being loaded into the dumpsters and hauled away to the landfill for proper disposal.
14:00-14:30	IH collected air samples and samplers and exited the Site.
18:00-19:30	IH prepared air samples and performed air sample analysis via PCM. All air samples were below 0.01 f/cc.



AIR SAMPLE DATA SHEET

Client: MCPS **Project Name:** Joann Leleck Elementary School
Work Area: Along the Fence **Date:** 10/31/2024

Sample NO.	Location / Code Relation to work	FLOW RATE		Time		Total Time	Total Volume	Fibers	Fibers CC
		Start	End	On	Off				
103124-1	Environmental-Main Entrance on Fence	3	3	7:20	14:00	400	1200	3	< 0.01
103124-2	Environmental-Facing White Apartments	3	3	7:21	14:03	402	1206	4.5	< 0.01
103124-3	Environmental-Facing House 705	3	3	7:23	14:05	402	1206	3	< 0.01
103124-4	Environmental-Facing Brown Apts.	3	3	7:26	14:08	402	1206	6.5	< 0.01
103124-5	Environmental-Facing Brown Apts.	3	3	7:27	14:09	402	1206	5.5	< 0.01
103124-6	Environmental-Facing St. Camillus	3	3	7:35	14:15	400	1200	3	< 0.01
103124-7	Environmental-Facing St. Camillus	3	3	7:38	14:16	398	1194	4.5	< 0.01
103124-8	Environmental-Facing Playground	3	3	7:42	14:19	397	1191	2.5	< 0.01
103124-9	Environmental-Facing Playground	3	3	7:43	14:20	397	1191	3.5	< 0.01
103124-10	Environmental-Facing Gym	3	3	7:47	14:23	396	1188	6	< 0.01
103124-11	Environmental-Facing Gym	3	3	7:48	14:24	396	1188	3	< 0.01
103124-12	Environmental-Facing Field	3	3	7:52	14:27	395	1185	5.5	< 0.01
Abbreviations:									
	PRE - Pre-Abatement Sampling	BLK - Blank		NFO - No Fibers Observed					
	OGBA - Outside Glove Bag Area	IWA - Inside Work Area		Post - Final Clearance monitoring					
	IGBA - Inside Glove Bag Area	OWA - Outside Work Area		AMB - Ambient					
	PRS - Personal Sample	OBT - Outside Barrier Tape		CB - Critical Barrier					
	IBT - Inside Barrier Tape								

Analyst: John Ndanga
Date: 10/31/2024



YOTN.N. & ASSOCIATES, INC (YNN)
Industrial Hygiene and Environmental Services

AIR SAMPLE DATA SHEET

Client: MCPS **Project Name:** Joann Leleck Elementary School
Work Area: Along the Fence **Date:** 10/31/2024

Sample NO.	Location / Code Relation to work	FLOW RATE		Time		Total Time	Total Volume	Fibers	Fibers CC
		Start	End	On	Off				
103124-13	Environmental-Facing Field	3	3	7:54	14:29	395	1185	5.5	< 0.01
103124-14	BLK								NFO
103124-15	BLK								NFO
Abbreviations:		PRE - Pre-Abatement Sampling	BLK - Blank				NFO - No Fibers Observed		
	OGBA - Outside Glove Bag Area	IWA - Inside Work Area					Post - Final Clearance monitoring		
	IGBA - Inside Glove Bag Area	OWA - Outside Work Area					AMB - Ambient		
	PRS - Personal Sample	OBT - Outside Barrier Tape					CB - Critical Barrier		
	IBT - Inside Barrier Tape								

Analyst: John Ndanga
Date: 10/31/2024



YOTI N.N. & ASSOCIATES, INC (YNN)

Industrial Hygiene and Environmental Services

AIR SAMPLE DATA SHEET

Client: MCPS Project Name: Joann Leleck Elementary School
 Work Area: Along the Fence Date: 11/2/2024

Sample NO.	Location / Code Relation to work	FLOW RATE		Time		Total Time	Total Volume	Fibers	Fibers CC
		Start	End	On	Off				
110224-1	Environmental-Main Entrance on Fence	4	4	9:00	15:00	360	1440	3	< 0.01
110224-2	Environmental-Facing White Apartments	4	4	9:01	15:01	360	1440	2	< 0.01
110224-3	Environmental-Facing House 705	4	4	9:03	15:03	360	1440	3.5	< 0.01
110224-4	Environmental-Facing Brown Apts.	4	4	9:06	15:05	359	1436	3	< 0.01
110224-5	Environmental-Facing Brown Apts.	4	4	9:07	15:06	359	1436	3.5	< 0.01
110224-6	Environmental-Facing St. Camillus	4	4	9:11	15:10	359	1436	2.5	< 0.01
110224-7	Environmental-Facing St. Camillus	4	4	9:12	15:11	359	1436	2	< 0.01
110224-8	Environmental-Facing Playground	4	4	9:15	15:12	357	1428	3	< 0.01
110224-9	Environmental-Facing Playground	4	4	9:16	15:14	358	1432	3.5	< 0.01
110224-10	Environmental-Facing Gym	4	4	9:17	15:16	359	1436	2.5	< 0.01
110224-11	Environmental-Facing Gym	4	4	9:19	15:17	358	1432	3.5	< 0.01
110224-12	Environmental-Facing Field	4	4	9:23	15:19	356	1424	2.5	< 0.01
Abbreviations: PRE - Pre-Abatement Sampling OGBA - Outside Glove Bag Area IGBA - Inside Glove Bag Area PRS - Personal Sample IBT - Inside Barrier Tape BLK - Blank IWA - Inside Work Area OWA - Outside Work Area OBT - Outside Barrier Tape NFO - No Fibers Observed Post - Final Clearance monitoring AMB - Ambient CB - Critical Barrier									

Analyst: John Ndanga
 Date: 11/2/2024



YOTI N.N. & ASSOCIATES, INC (YNN)

Industrial Hygiene and Environmental Services

AIR SAMPLE DATA SHEET

Client: MCPS

Project Name: Joann Leleck Elementary School

Work Area: Along the Fence

Date: 11/2/2024

Sample NO.	Location / Code Relation to work	FLOW RATE		Time		Total Time	Total Volume	Fibers	Fibers CC
		Start	End	On	Off				
110224-13	Environmental-Facing Field	4	4	9:25	15:20	355	1420	2	< 0.01
110224-14	BLK								NFO
110224-15	BLK								NFO
Abbreviations: PRE - Pre-Abatement Sampling OGBA - Outside Glove Bag Area IGBA - Inside Glove Bag Area PRS - Personal Sample IBT - Inside Barrier Tape BLK - Blank IWA - Inside Work Area OWA - Outside Work Area OBT - Outside Barrier Tape NFO - No Fibers Observed Post - Final Clearance monitoring AMB - Ambient CB - Critical Barrier									

Analyst: John Ndanga

Date: 11/2/2024



YOTI N.N. & ASSOCIATES, INC (YNN)

Industrial Hygiene and Environmental Services

DAILY LOG SHEET

Date: 11/3/2024

Job Name: Joann Leleck ES

Time	Remarks
9:30	YNN's field IH arrived at Joann Leleck Elementary school (Site) to perform environmental
	(fiber-in-air) sampling following the fire incident which resulted in almost total colaps of the
	building structure. The Site is located at 710 Beacon Road in Silver Spring, Maryland.
	The Contractors are all off for the weekend. IH calibrated air samplers at 4 l/m and commenced
	environmental air sampling.
10:00	IH completed setting up air samplers.
13:00	IH performed a walk through of the area and checked on the air samplers. Air samplers were
	sampling along the erected fence surrounding the demolished building structure.
	Samples were strategically positioned to capture air quality in different sections of the
	demolished building structure.
15:00	IH started collecing air samplers.
15:30	IH exited the Site.
16:45	IH prepared air samplers and performed air sample analysis.
18:15	IH completed air sample analysis. All air samples were below 0.01 f/cc.



YOTI.N.N. & ASSOCIATES, INC (YNN)

Industrial Hygiene and Environmental Services

AIR SAMPLE DATA SHEET

Client: MCPS **Project Name:** Joann Leleck Elementary School

Work Area: Along the Fence **Date:** 11/3/2024

Sample NO.	Location / Code Relation to work	FLOW RATE		Time		Total Time	Total Volume	Fibers	Fibers CC
		Start	End	On	Off				
110324-1	Environmental-Main Entrance on Fence	4	4	9:30	15:00	330	1320	1.5	< 0.01
110324-2	Environmental-Facing White Apartments	4	4	9:31	15:02	331	1324	2.5	< 0.01
110324-3	Environmental-Facing House 705	4	4	9:32	15:03	331	1324	1.5	< 0.01
110324-4	Environmental-Facing Brown Apts.	4	4	9:35	15:06	331	1324	2.5	< 0.01
110324-5	Environmental-Facing Brown Apts.	4	4	9:36	15:07	331	1324	3.5	< 0.01
110324-6	Environmental-Facing St. Camillus	4	4	9:40	15:11	331	1324	3	< 0.01
110324-7	Environmental-Facing St. Camillus	4	4	9:41	15:12	331	1324	3.5	< 0.01
110324-8	Environmental-Facing Playground	4	4	9:43	15:14	331	1324	2.5	< 0.01
110324-9	Environmental-Facing Playground	4	4	9:44	15:15	331	1324	2	< 0.01
110324-10	Environmental-Facing Gym	4	4	9:46	15:18	332	1328	3.5	< 0.01
110324-11	Environmental-Facing Gym	4	4	9:47	15:19	332	1328	1.5	< 0.01
110324-12	Environmental-Facing Field	4	4	9:49	15:22	333	1332	2.5	< 0.01

Abbreviations: PRE - Pre-Abatement Sampling
 OGBA - Outside Glove Bag Area
 IGBA - Inside Glove Bag Area
 PRS - Personal Sample
 IBT - Inside Barrier Tape

BLK - Blank
 IWA - Inside Work Area
 OWA - Outside Work Area
 OBT - Outside Barrier Tape

NFO - No Fibers Observed
 Post - Final Clearance monitoring
 AMB - Ambient
 CB - Critical Barrier

Analyst: John Ndanga
Date: 11/3/2024



YOTI N.N. & ASSOCIATES, INC (YNN)

Industrial Hygiene and Environmental Services

AIR SAMPLE DATA SHEET

Client: MCPS **Project Name:** Joann Leleck Elementary School

Work Area: Along the Fence **Date:** 11/3/2024

Sample NO.	Location / Code Relation to work	FLOW RATE		Time		Total Time	Total Volume	Fibers	Fibers CC
		Start	End	On	Off				
110324-13	Environmental-Facing Field	4	4	9:51	15:24	333	1332	3	< 0.01
110324-14	BLK								NFO
110324-15	BLK								NFO

Abbreviations: PRE - Pre-Abatement Sampling
 OGBA - Outside Glove Bag Area
 IGBA - Inside Glove Bag Area
 PRS - Personal Sample
 IBT - Inside Barrier Tape

BLK - Blank
 IWA - Inside Work Area
 OWA - Outside Work Area
 OBT - Outside Barrier Tape

NFO - No Fibers Observed
 Post - Final Clearance monitoring
 AMB - Ambient
 CB - Critical Barrier

Analyst: John Ndanga **Date:** 11/3/2024

Field

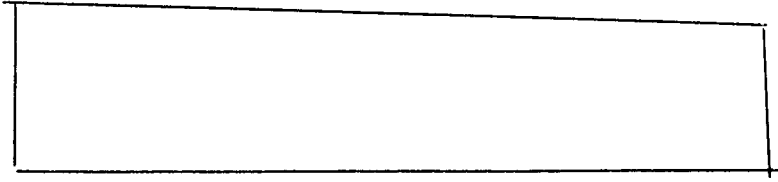

Playground

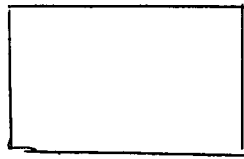

Fence

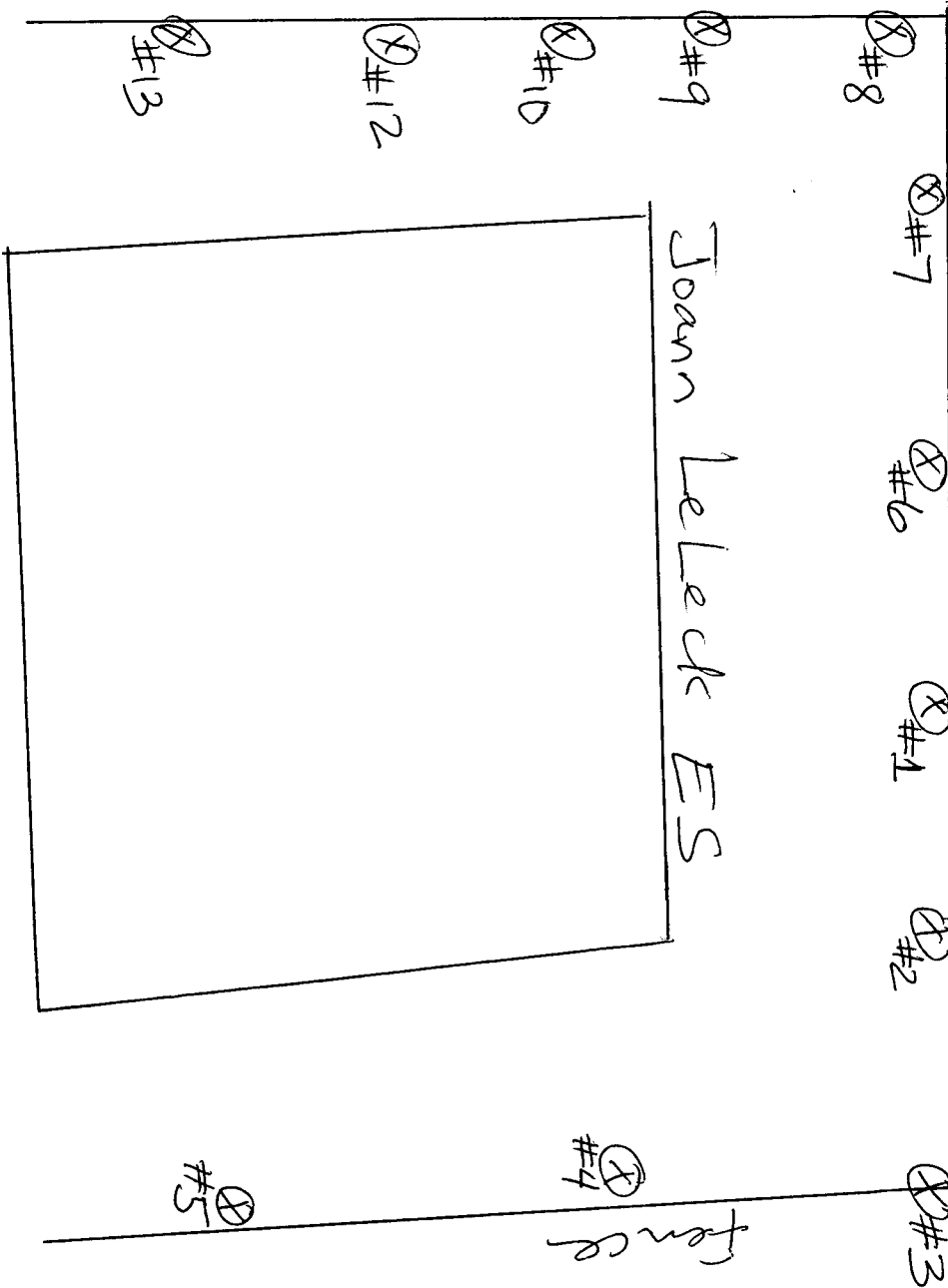

St. Camillus School

White Brick Apartments

House #705



Brown Brick Apartments

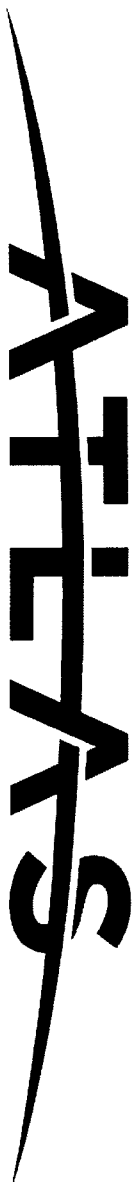

Approval No.: 21 13 01

Certificate of Achievement

Awarded to

John Ndanga

In recognition of successful completion of the course entitled

ASBESTOS ABATEMENT SUPERVISOR REVIEW

An 8-Hour annual refresher program of study presented in accordance with the provisions of the U.S. Environmental Protection Agency Model Accreditation Plan 40 CFR Part 763, Appendix C to SUBPART E, for Accreditation under TSCA Title II



23-1103

Certificate Number

Location: Columbia, MD

November 18, 2023

Examination Date

November 18, 2024

November 18, 2023

Course Date

9231 Rumsey Road Columbia, Maryland 21045

410-381-0232 Office

410-423-9235 Direct

Clayton E. Miller Course Instructor

Handwritten signature of Clayton E. Miller in black ink.

Carla M. Gomez Course Director

Handwritten signature of Carla M. Gomez in black ink.

THE
DEEP SOUTH CENTER FOR OCCUPATIONAL
HEALTH AND SAFETY

CERTIFIES THAT

John Ndanga

HAS SATISFACTORILY COMPLETED

Sampling and Evaluating Airborne Asbestos Dust—NIOSH 582
Birmingham, Alabama
November 9-12, 1987

AND IS HEREBY AWARDED THIS CERTIFICATE

PROGRAM DIRECTOR



A NIOSH-Supported Educational Resource Center
University of Alabama at Birmingham & Auburn University

COURSE INSTRUCTOR

